

UQ140 KARLSKOGA (SE) EMBRACE COMMUNITY

Embrace Karlskoga creates blocks with a variety of inclusive urban typologies. Each typology, the green urban block, the makers square, living in the park and the grower's plot, embraces different values found around the site, enabling many contemporary ways of living. Inspired by older housing projects in Karlskoga the typologies stimulate the development of communities. On different scales, ranging from the individual housing complex to the amenities of the whole development, inhabitants and visitors are encouraged to meet, share, and live with one another. Each typology is shaped by four parameters to optimize variety.

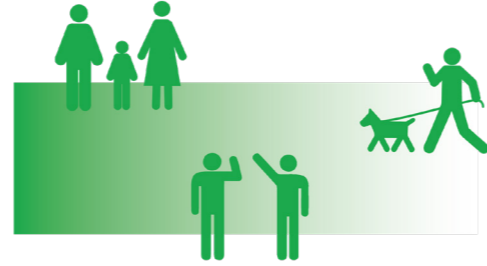

Diversify housing

Every block contains multiple housing typologies to stimulate interaction between people in different phases of life, household compositions and levels of income.



Share!

Sharing is necessary due to the limited resources of our planet. Inhabitants share (work)spaces as well as amenities within the building, block or even within the district, what is shared is defined by the block-typology. The shared programme enlivens the working spaces.

Communal spaces

A smart gradient from public to private is applied to indoor and outdoor spaces. The communal spaces enrich everyday life within the buildings and the blocks.

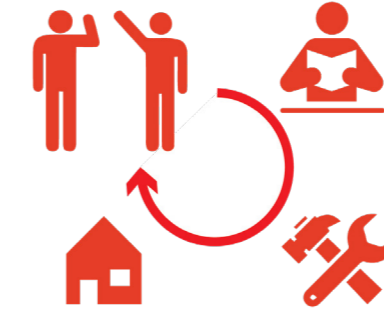

Stimulate social cohesion

Part of the buildings will be designed and constructed by their future inhabitants, allowing people to create work and living spaces tailored to their preferences. Their commitment to the development process creates strong binding with the neighbourhood.

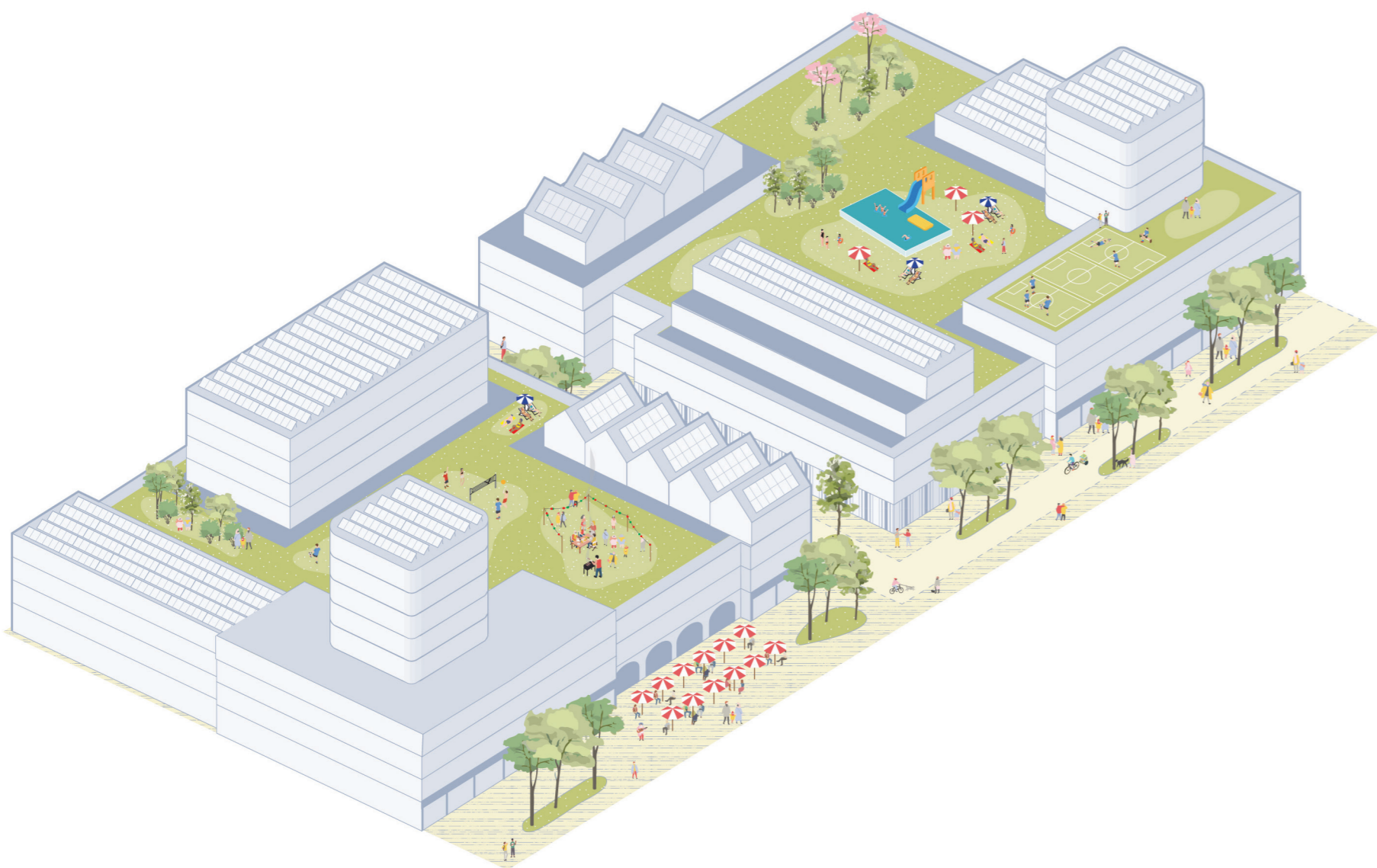

THE GREEN URBAN BLOCK

The green urban blocks urban have a similar scale as the existing big-box stores. The blocks provide higher density living and lively streets with plenty of services, like a doctor's office, hairdressers and supermarkets, and amenities like gyms, restaurants and shops. Roof gardens are lushly planted and the streets are lined with trees.



Housing diversity

- Differently sized apartments e.g. split level, studio's and lofts
- Private outdoor spaces are mostly balconies and roof terraces

Communal spaces

Large roof gardens with outdoor furnishing are shared by the inhabitants of the block

Shared programme

Each block has a shared work spaces and quick access to the publically accessible amenities and shops in the plinths and the terraces on the streets and squares

Self-organized

10% of the apartment buildings are completed as shells, for inhabitants to organize and structure

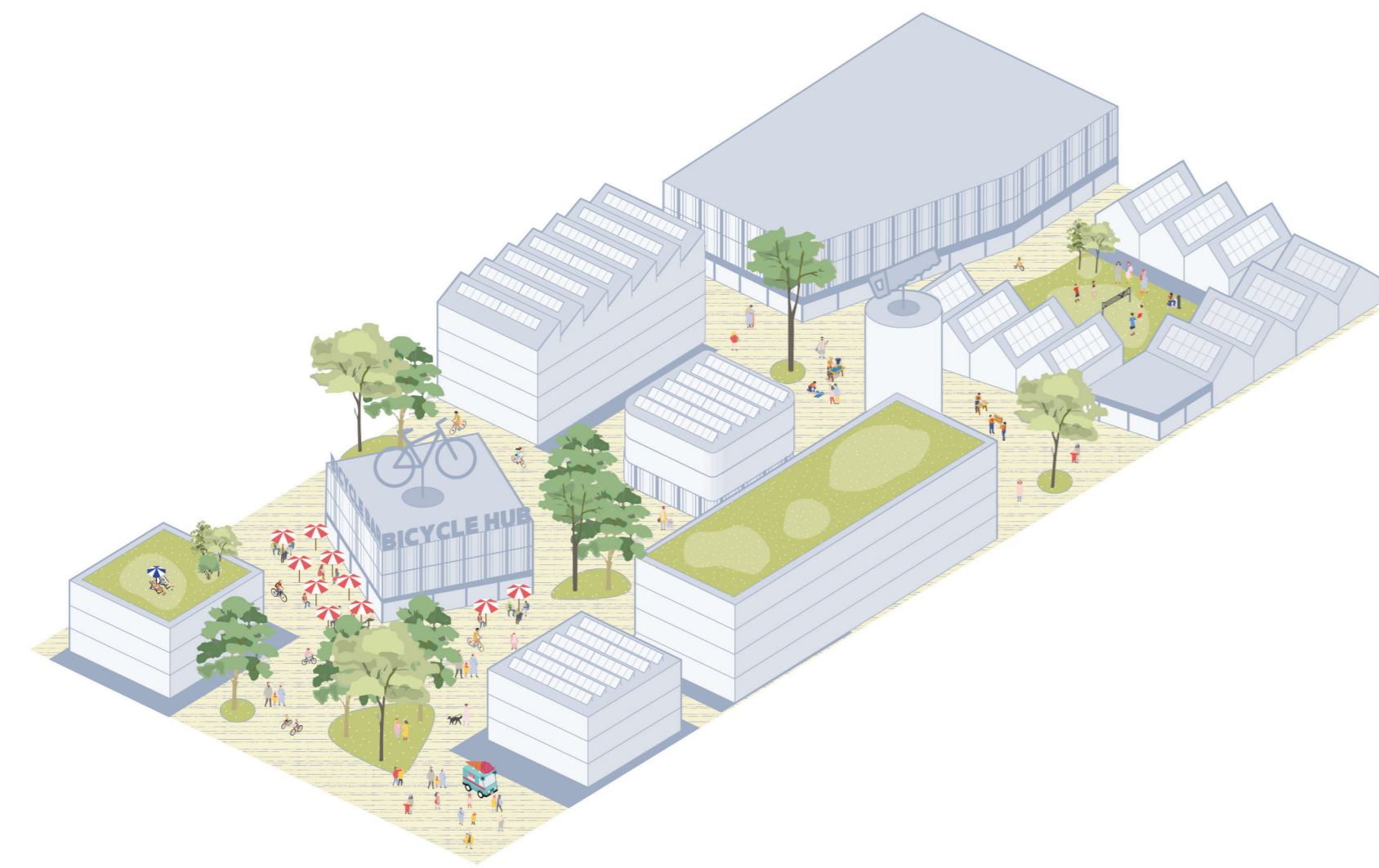
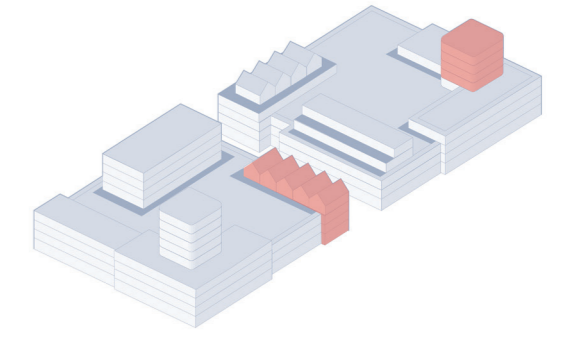
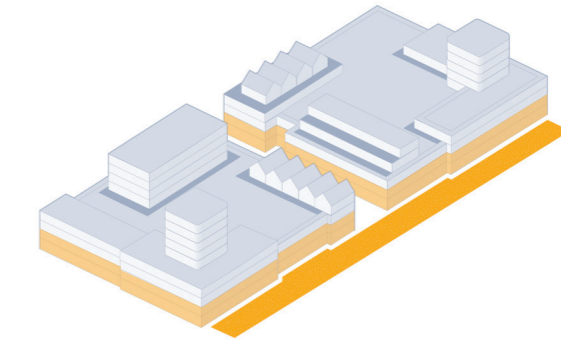
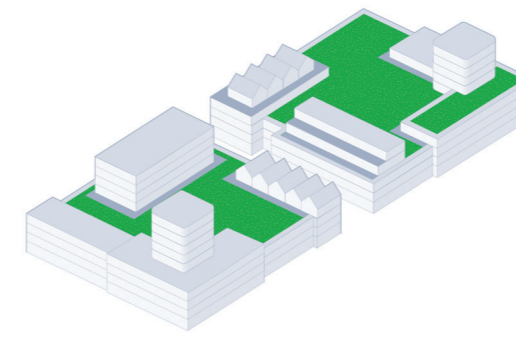
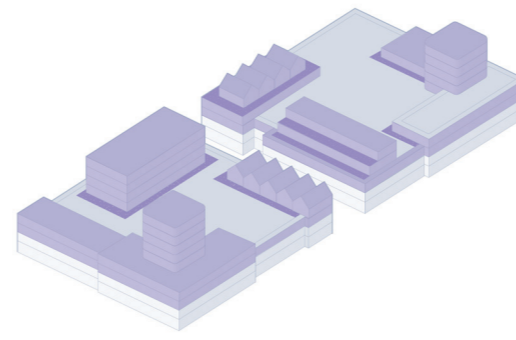

MAKERS SQUARE

Makers square revolves around crafts and handwork. Inhabitants work alongside eachother in shared studio's and workshops and display or sell their work in a local gallery or shopfront. The shared activities take place on and around the squares. The blocks are relatively dense, but more oriented towards the ground floor and with more public spaces than the green urban blocks.

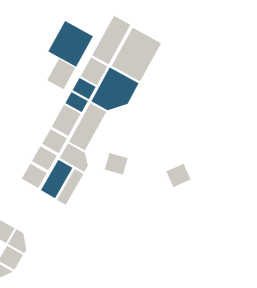

Housing diversity

- Terraced housing and apartments e.g. split level, studio's and lofts
- Private outdoor spaces are balconies, roof terraces and groundfloor terraces

Communal spaces

Inhabitants share offices, workshop and studio spaces as well as courtyards and roof gardens

Shared programme

- Shared amenities like flexible office spaces/workshops
- Public services (i.e. galleries, flexible shops, music studio's) and restaurants/bars in the plinths

Self-organized

All individual housing is self-built and has a dual designation of housing and office/workspace. 5% of the apartment buildings are completed as shells

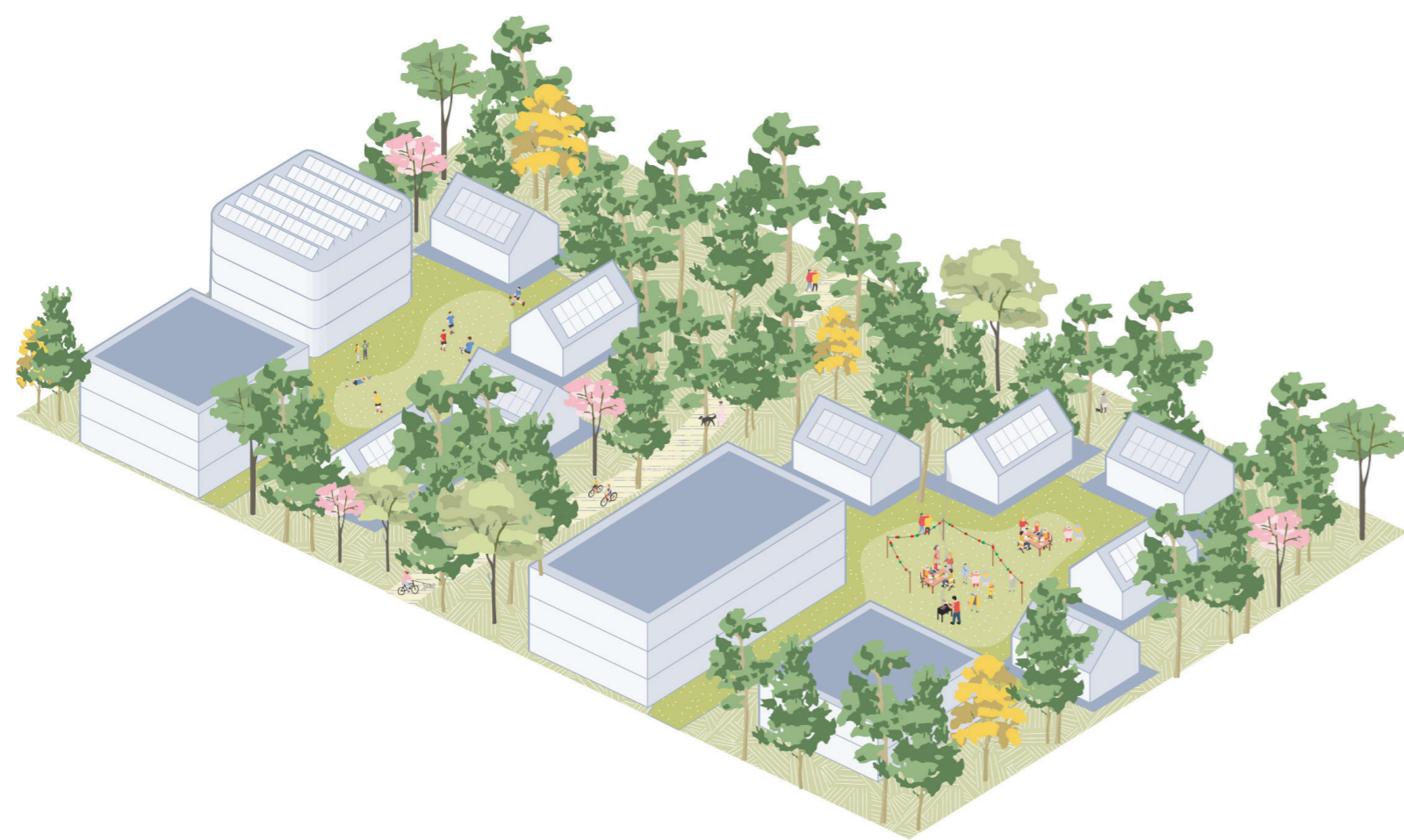
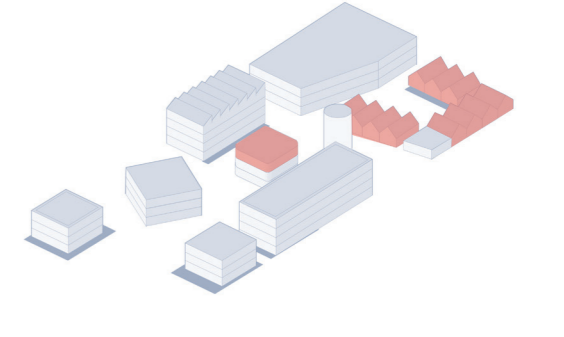
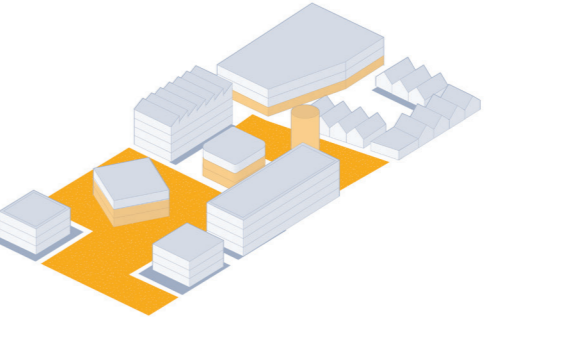
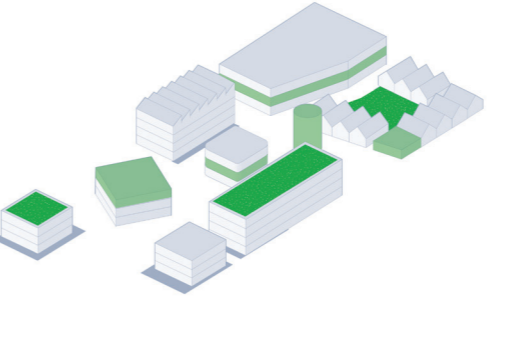
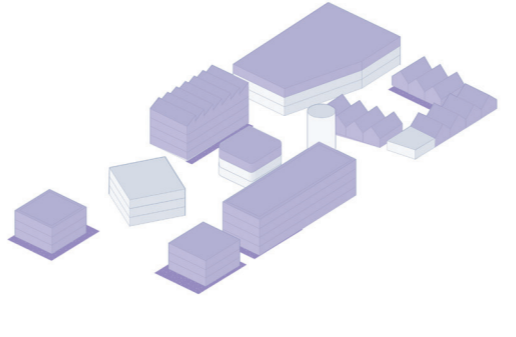

LIVING IN THE PARK

The park engulfs some of the blocks, providing clusters of low-density housing in green forested surroundings. The park-blocks offer many of the same qualities as the villa-areas of Karlskoga like spacious housing and safe playspaces for children, but combined with more communal living and a high standard of biodiversity.



Housing diversity

- Terraced housing, villas and apartments
- Private outdoor spaces are roof gardens and terraces oriented towards the park

Communal spaces

Inhabitants share courtyards with space for sports, gatherings and gardening.

Shared programme

The housing clusters are part of the public park and contribute to its programming (e.g. playgrounds, performance spaces and outdoor equipment rental)

Self-organized

50% of the villa's are self-built. 50% of the apartment buildings are completed as shells

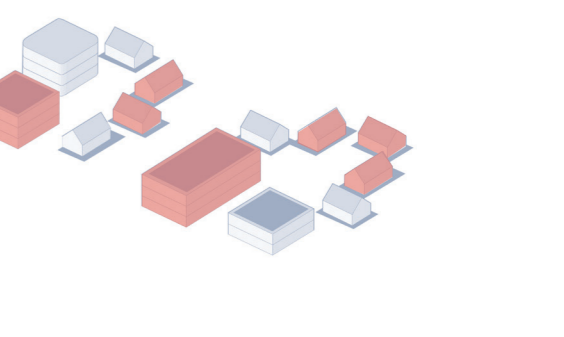
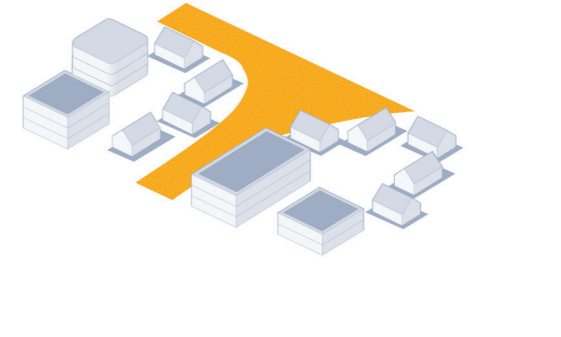
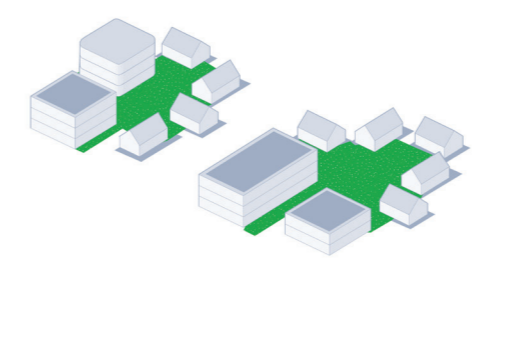
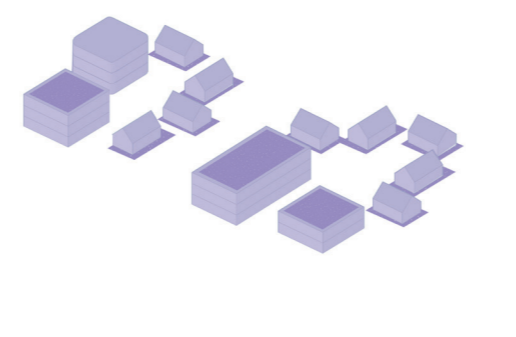

THE GROWER'S PLOT

The epitome of communal living. The inhabitants of the grower's plot grow their own food and maintain the agricultural fields and historic farms of the area. In return they get large shared spaces and high quality housing, as well as the chance to uphold a largely self sustaining lifestyle.

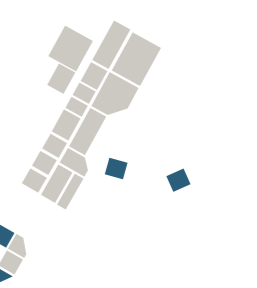

Housing diversity

- Terraced housing, villas and tiny houses
- Private outdoor spaces are terraces oriented towards the meadows, orchard and creeks

Communal spaces

Inhabitants share are large courtyard with space for allotment gardens and tend the surrounding farmland and orchards

Shared programme

5% of the buildings have a public function (i.e. farm shop) 5% of the arable land has public programming (i.e. petting zoo) The meadows is a temporary space for large events/festivals

Self-organized

50% of the villa's and all tiny houses are self-built.

